

Standard hub detachable claw rings and flexible ring

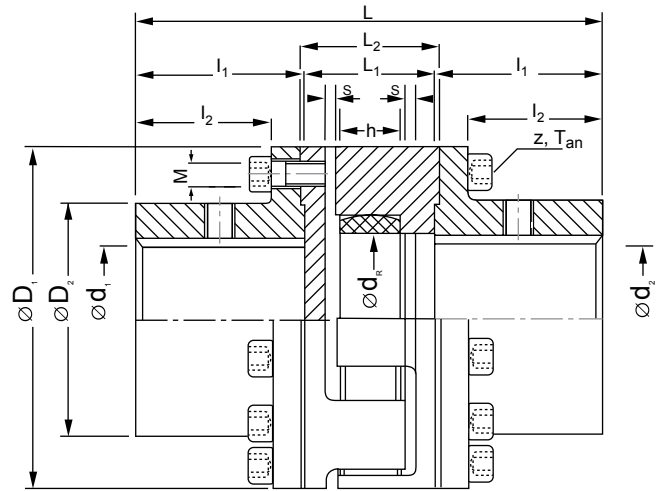

Size	Nominal torque	Max torque	Max speed	Max bore	Dimensions										Quantity of bolts	Tightening torque	Total weight	Moments of inertia
Series TMS	T_{KN} 80 sh 93 sh Nm	T_{Kmax} 80 sh 93 sh Nm	n_{max} min^{-1}	d_1/d_2 max mm	D_1 mm	D_2 mm	h mm	l_1 mm	l_2 mm	L_1 mm	L_2 mm	L mm	s mm	M DIN 912 mm	Z	Tan Nm	kg	J_1/J_2 Kg* m^2
85 DD	- 75	- 225	9 000	38/38	85	60	21	43.0	33.5	43	46	129	4.0+2.0	6	6	10	3.0	0.0014 0.0014
100 DD	65 130	195 390	7 250	42/42	105	65	24	49.0	37.5	53	56	151	5.0+2.5	8	9	25	4.9	0.0027 0.0027
125 DD	125 250	375 750	6 000	55/55	126	80	29	56.0	43.5	58	61	170	5.0+3.0	10	9	49	7.7	0.0085 0.0085
145 DD	200 400	600 1 200	5 250	65/65	145	90	34	60.5	47.0	68	71	189	5.0+3.0	12	9	85	11.8	0.0143 0.0143
170 DD	315 630	945 1 900	4 500	80/80	170	115	34	74.5	60.5	68	71	217	5.0+3.5	12	12	85	16.7	0.036 0.036
200 DD	550 1 100	1 650 3 300	3 750	95/95	200	135	40	98.5	82.0	77	81	274	6.0+4.0	14	12	135	30.5	0.071 0.071
230 DD	850 1 700	2 550 5 150	3 250	110/110	230	150	41	110.0	90.0	81	86	301	7.0+4.5	14	15	135	48.7	0.132 0.132
260 DD	1 330 2 650	4 000 7 950	3 000	130/130	260	180	52	112.5	87.5	96	101	321	8.0+5.0	16	15	210	69.5	0.26 0.26
300 DD	1 950 3 900	5 850 11 700	2 500	145/145	300	200	57	131.5	107.0	113	118	376	8.0+5.0	20	15	425	103.0	0.44 0.44
360 DD	3 250 6 500	9 700 19 500	2 150	160/160	360	225	62	172.0	144.5	125	130	469	8.0+5.0	24	12	730	163.0	0.91 0.91
400 DD	4 450 8 900	13 800 26 700	1 900	170/170	400	240	62	172.0	144.5	125	130	469	8.0+5.0	24	14	730	173.5	1.12 1.12